

Z40H MINI-SPLIT CONDENSATE PUMP

Submittal Information

Part No.	18103
Document No.	SPEC18103
Date	2025-05-13
Revision	02

General Properties

- Power supply: 100-240V AC 50/60Hz <4W
- Max.flow: 40L(10.57 gal)/H, range from 20-40L(5.28-10.57 gal)/H
- Max.recommended head: 20m (65.62 ft)
- Max.suction lift: 2m (6.56 ft)
- Max.unit output: 46KW / 157,000 Btu/h
- Max.water temperature: 40°C (104°F)
- Discharge tube: 6mm (1/4 in) ID
- Class: II appliance
- Protection: Fully potted, IP-45

Specification

Item No.	Description	Std. Pkg	U/M
18103	Z40H Mini-split Pump, Upgrade Sensor, Dual Vol, 10.6 GPH	1	EA

Features

- Operates with low noise for a quiet environment.
- Features safe and reliable water detection using a capacitive sensor.
- Offers large flow capacity for efficient condensate drainage.
- Automatic flow adjustment reduces noise and extends pump lifespan.
- Designed for easy cleaning and maintenance.

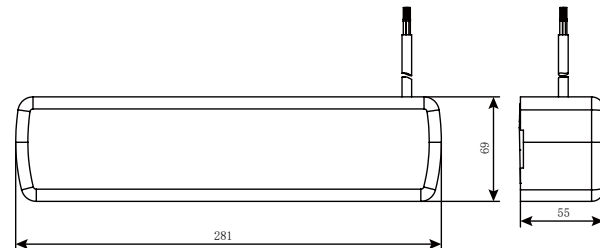

- 281 mm = 11.06 in
- 55 mm = 2.17 in
- 69 mm = 2.72 in

Accessories List

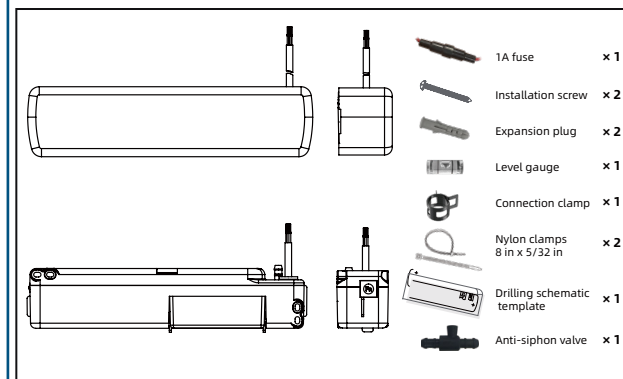

Performance Data

